

FINAL DRAWING - FOR REVIEW PURPOSES ONLY

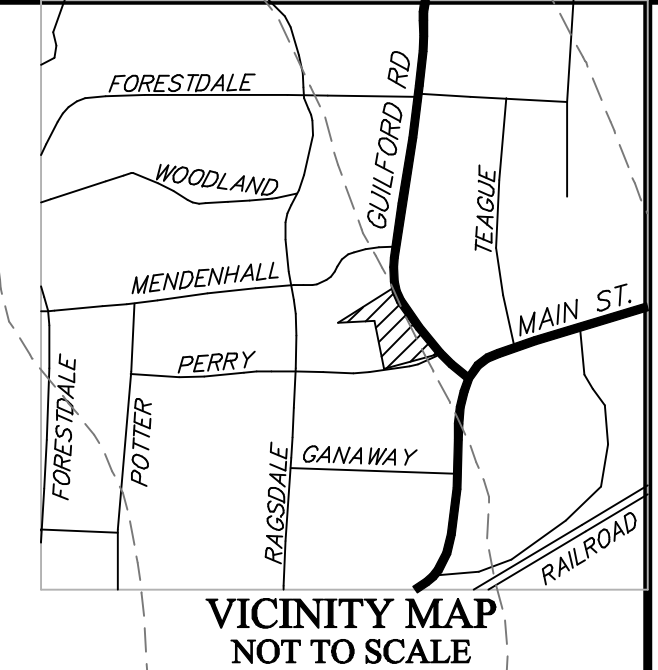

OWNER:
TOWN OF JAMESTOWN
 P.O. BOX 848
 JAMESTOWN, N.C. 27282
 PHONE: (336) 454-1138
 FAX: (336) 886-3504
 CONTACT:
MATTHEW L. JOHNSON, AICP
 PLANNING DIRECTOR
 EMAIL: mjohnson@jamestown-nc.gov



Civil Engineering by:
TOWN OF JAMESTOWN
 PUBLIC SERVICES DEPARTMENT
 301 EAST MAIN STREET
 JAMESTOWN, NORTH CAROLINA 27282
 TELEPHONE 336 454-1138 FAX 336 886-3504
 EMAIL: pbanchard@jamestown-nc.gov

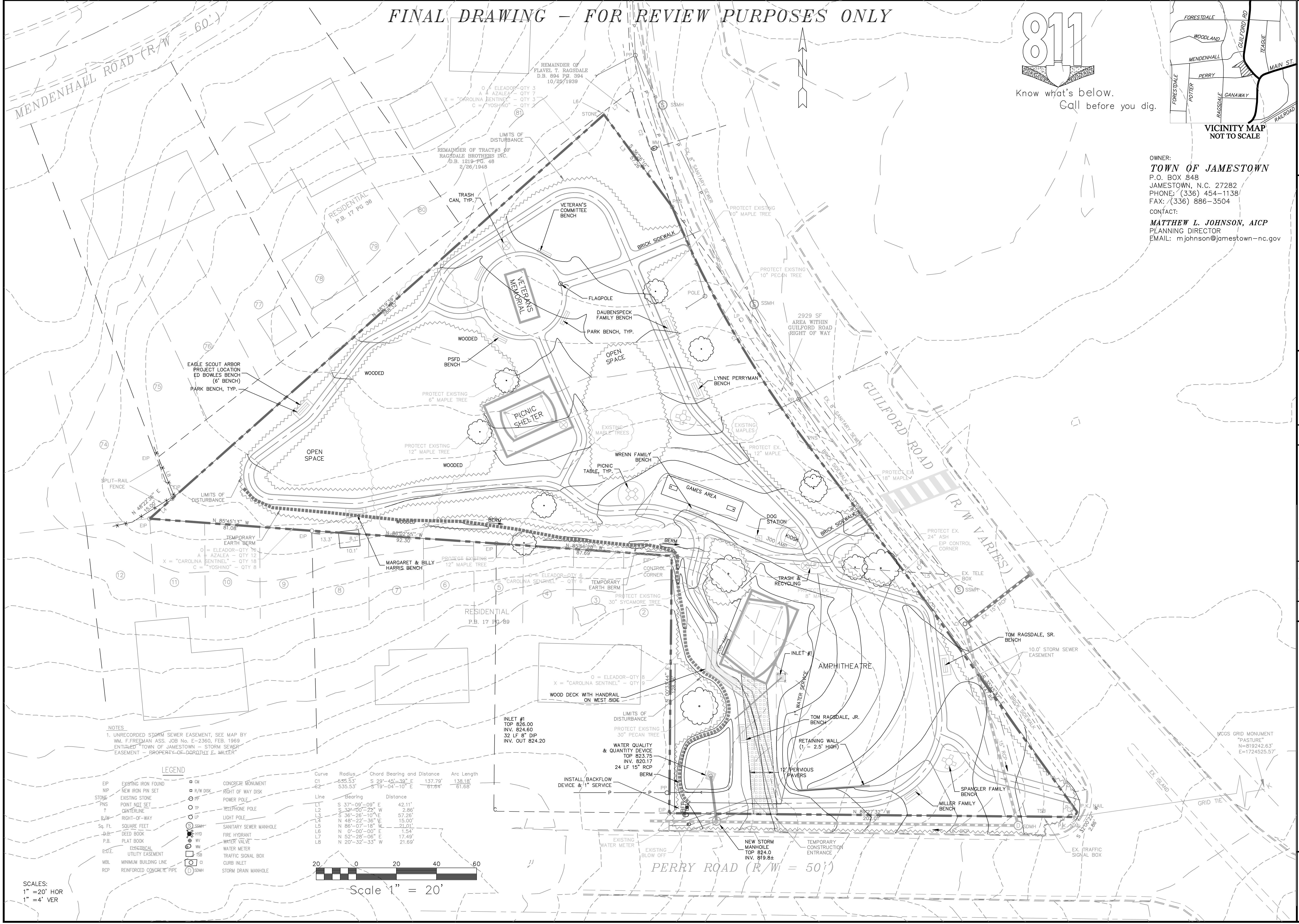

NOTES
 1. UNRECORDED STORM SEWER EASEMENT, SEE MAP BY WM. F. FREEMAN ASS. JOB No. E-2360, FEB. 1969 ENTITLED "TOWN OF JAMESTOWN - STORM SEWER EASEMENT - PROPERTY OF DOROTHY F. WALTER"

LEGEND

EIP	EXISTING IRON FOUND	□	CONCRETE MONUMENT
NP	NEW IRON PIN SET	○	RIGHT OF WAY DISK
STONE	EXISTING STONE	○	POWER POLE
PNS	POINT NO.1 SET	○	TELEPHONE POLE
?	CENTERLINE	○	LIGHT POLE
R/W	RIGHT-OF-WAY	○	SANITARY SEWER MANHOLE
Sq. Ft.	SQUARE FEET	○	FIRE HYDRANT
D.B.	DEED BOOK	○	WATER VALVE
P.B.	PLAT BOOK	○	WATER METER
E.C.E.	ELECTRICAL UTILITY EASEMENT	○	TRAFFIC SIGNAL BOX
MBL	MINIMUM BUILDING LINE	○	CURB INLET
RCP	REINFORCED CONCRETE PIPE	○	STORM DRAIN MANHOLE

Curve	Radius	Chord Bearing and Distance	Arc Length
C1	555.53'	S 29°-45'-39" E 137.79'	138.18'
C2	535.53'	S 19°-04'-10" E 61.64'	61.68'

Line	Bearing	Distance
L1	S 37°-09'-09" E	42.11'
L2	S 32°-00'-22" W	2.86'
L3	S 36°-26'-10" E	37.26'
L4	N 48°-22'-36" E	15.00'
L5	N 86°-07'-18" W	21.01'
L6	N 0°-00'-00" E	1.54'
L7	N 52°-28'-08" E	17.49'
L8	N 20°-32'-33" W	21.69'

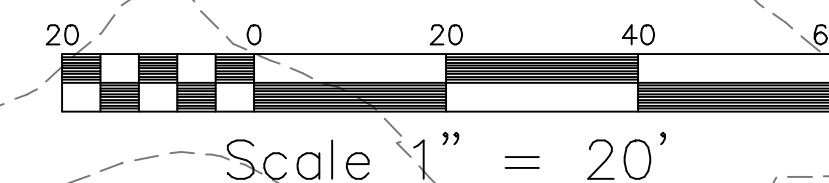

SCALES:
 1" = 20' HOR
 1" = 4' VER

REV.	DATE	DESCRIPTION	BY
1	6/05/13	UPDATES	

PRB	JOB NUMBER: 2013-01	DATE:	2/13/13
DESIGNED:	MLJ	DRAWN:	PRB
CHECKED:	PRB	SCALE: 1" = 20' HOR	N/A

GRADING, EROSION CONTROL & WATERSHED PLAN
TOWN OF JAMESTOWN
WRENN-MILLER PARK
 CONTRACT # PS 2013-01
 JAMESTOWN TOWNSHIP - GUILFORD COUNTY - NORTH CAROLINA